

# 8201PL-04TN-US

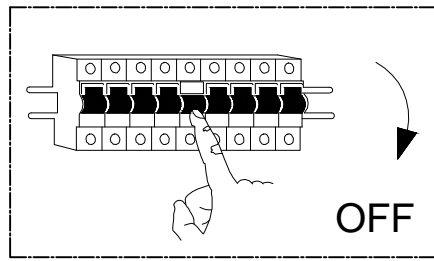

①



4\*E26

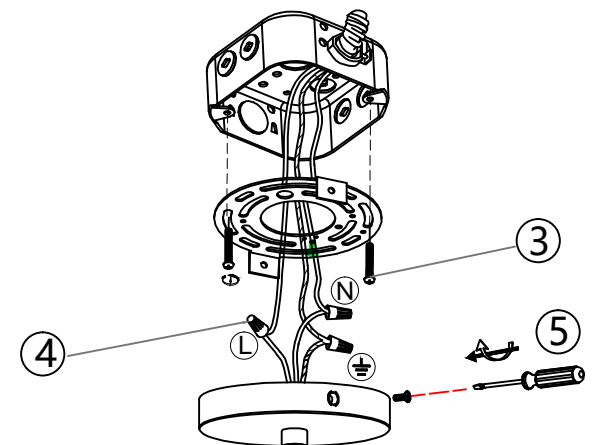
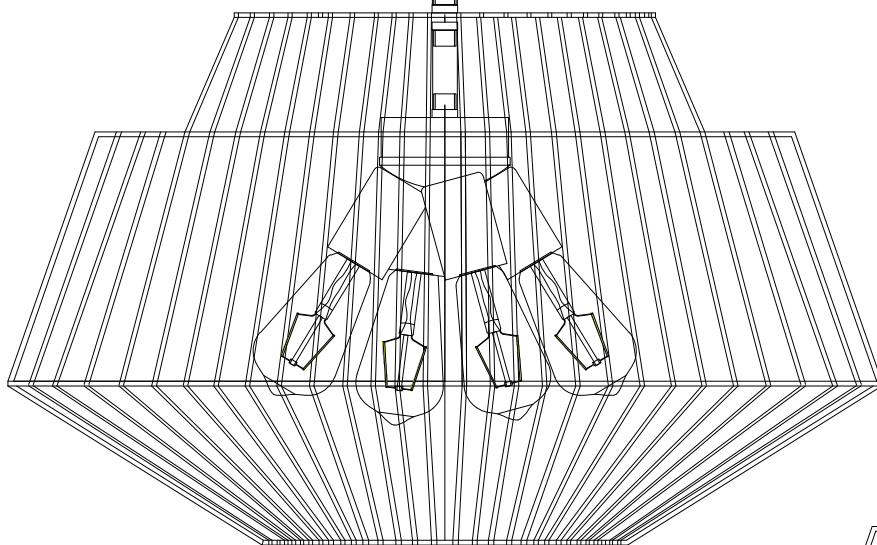

④

③

⑤

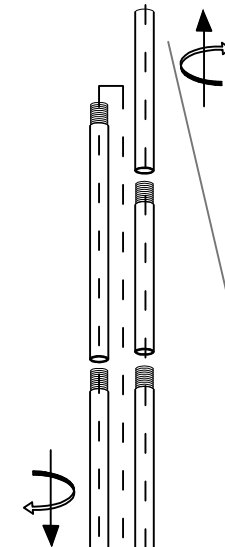

②

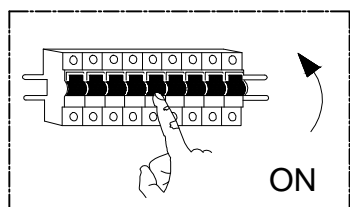

⑦

1 : Please turn off the power first.

2 : Connect the power cord and tighten the terminal.

3 : Screw the hanging board to the junction box.

4 : The screws on both sides of the STB are fixed on the hanging board.

5 : Screw the balance lever into the lamp body.

6 : Install the light bulb(E26 socket).

7 : Please turn On the power.

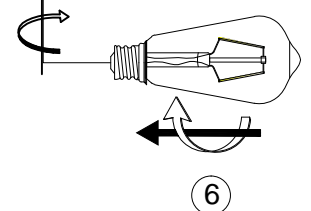

⑥