

# 8235PL-01GD-US

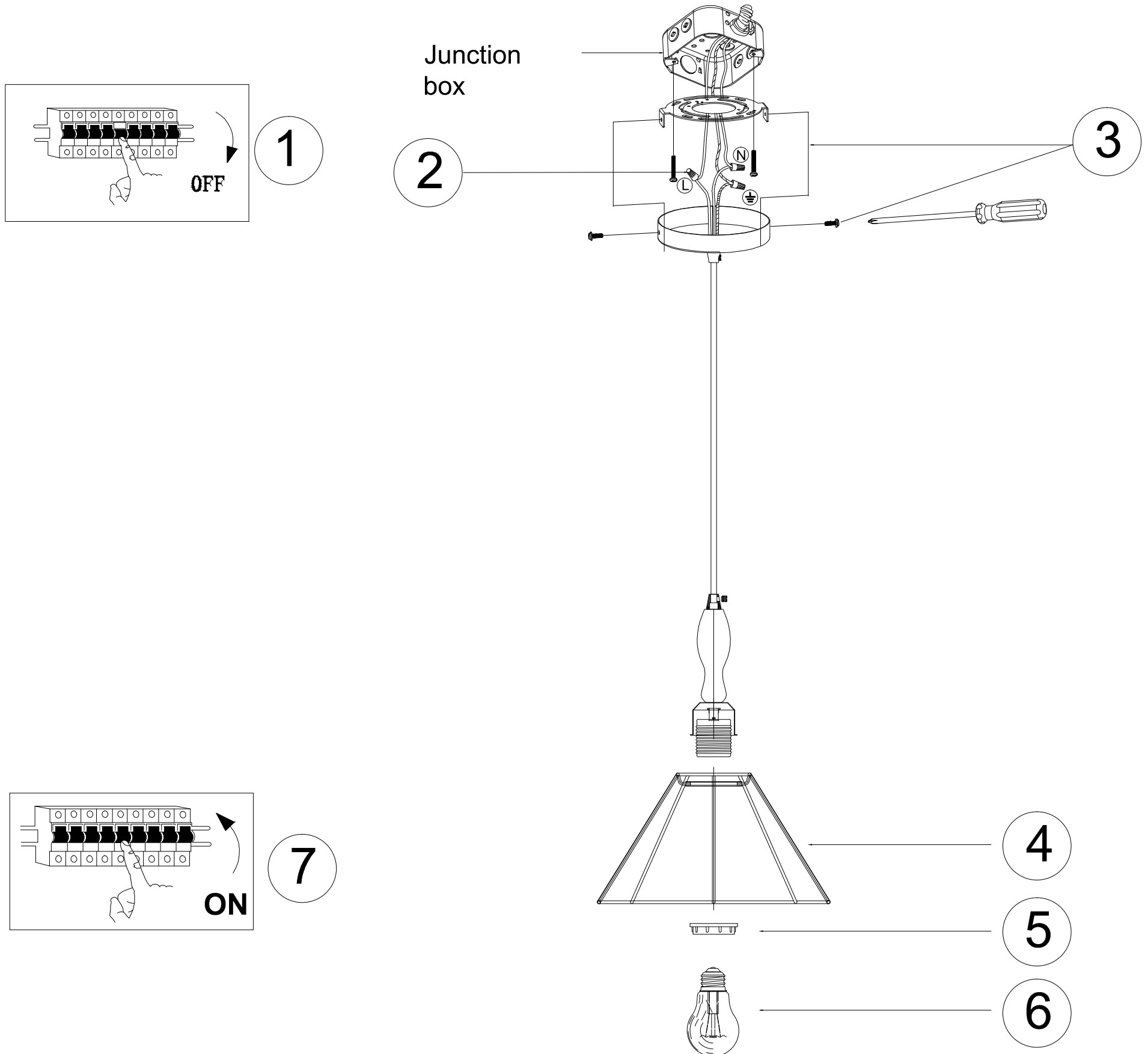

1 : Shut down the power.

2 : Screw on the terminal cap in the correct way

3 : Screw the mounting plate to the junction box Then fix the screws on both sides of the canopy.

4: Put the lampshade over the lamp socket.

5 : Fasten the lampshade tightly with the lamp collar..

6 : Turn the E26 bulb into the lamp socket.

7 : Turn on the main power supply, and the lights will come on.